

Emergency Luminaire for Fluorescent Lamps

Series 6018/1 made of Sheet Steel or Stainless Steel

STAHL



- For use in Zones 1, 2, 21 and 22
- Enclosure made from powdercoated sheet steel or stainless steel
- Central lock for opening and closing the luminaire plus a safety switch that disconnects the power supply at all poles when the luminaire is opened
- With weekly functional test and annual emergency lighting light duration test

E2

WebCode 6018B



The safety light made of 6018/1 series sheet steel is used for emergency lighting and suitable for use in spraying and painting systems. The battery powers the emergency lighting over 1.5 or 3 hours. In case of a defective lamp, the luminaire switches to the working lamp. In operation, their robust construction means that they require minimal maintenance. With the right accessories, these high-quality luminaires are easy to install in a wide variety of ways in no time at all.

	IECEx / ATEX					
Zone	0	1	2	20	21	22
Installation in		•	•		•	•

Selection Table–								
Version	2							
	Enclosure material	Drilled holes	Cable entries	Stopping plug	Threaded plate	Product Type	Art. No.	Weight kg
	1.4404 stainless steel, Powder-coated	3 x M20	Can be ordered as accessories	1 x M20	2x SS316L stainless steel	6018/1112-2961-1710-714	267779	14.883
	1.4404 stainless steel, Powder-coated	3 x M25	2 x M25 x 1.5	1 x M25	2x plastic	6018/1112-2962-1720-714	267774	14.883
	Sheet steel, Powder-coated	3 x M20	Can be ordered as accessories	1 x M20	2x SS316L stainless steel	6018/1112-2961-1710-711	267777	14.760
	Sheet steel, Powder-coated	3 x M25	2 x M25 x 1.5	1 x M25	2x plastic	6018/1112-2962-1710-711	267772	14.760
Version	4							
	Enclosure material	Drilled holes	Cable entries	Stopping plug	Threaded plate	Product Type	Art. No.	Weight kg
	1.4404 stainless steel, Powder-coated	3 x M20	Can be ordered as accessories	1 x M20	2x SS316L stainless steel	6018/1114-2961-1720-714	267781	22.869
	1.4404 stainless steel, Powder-coated	3 x M25	2 x M25 x 1.5	1 x M25	2x plastic	6018/1114-2962-1710-714	253604	22.869
	Sheet steel, Powder-coated	3 x M20	Can be ordered as accessories	1 x M20	2x SS316L stainless steel	6018/1114-2961-1720-711	267778	22.660
	Sheet steel, Powder-coated	3 x M25	2 x M25 x 1.5	1 x M25	2x plastic	6018/1114-2962-1710-711	267773	22.660

Cable entries and Stopping plug made from moulded material are included loose with the product (installation required).

The light fittings are supplied without lamps or mounting material.

To use the product as a recessed light fitting, a special recessed installation frame is required (in addition to the mounting material).

Technical Data

Explosion Protection

IECEX gas explosion protection	Ex eb db mb IIC T4 Gb
IECEX dust explosion protection	Ex tb IIIC T80 °C Db
ATEX gas explosion protection	Ex II 2 G Ex eb db mb IIC T4 Gb
ATEX dust explosion protection	Ex II 2 D Ex tb IIIC T80 °C Db
Certificates	ATEX (BVS), EAC (ENDCE), IECEX (BVS)
Note: Through wiring	max. 16 A

Electrical Data

Rated operational voltage AC	220 – 240 V
Battery operating voltage	6 V
Battery capacity	7 Ah
Frequency range	50 – 60 Hz
Self-test function	With (standard)

Ambient Conditions

Ambient temperature	-20 °C ... +50 °C Note: Through wiring max. 16 A
---------------------	--

Lighting Data

Number of lamps	2
Lamp	G13 lamp base
Emergency light duration	1,5 / 3 h (emergency light)

Mechanical Data

Degree of protection (IP)	IP65
Sealing material	Silicone foam gasket
Lens material	Safety glass
Material translucent cover	Hardened glass
Installed terminal strip	PE + N + L1 + L2 + L3 + L'
Connection terminals solid max.	4 mm²
Connection terminals finely-stranded max.	4 mm²
Enclosure colour	White, RAL 9016

Components

Through wiring	With 6 conductors 2.5 mm²
----------------	---------------------------

Accessories

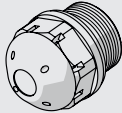
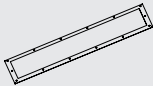
Figure	Description	Art. No.	Weight kg
Breather			
	Thread: M25 x 1.5; 1 pc; for installation in lights; in moulded material; without counter nut	138573 ▲	0.010
	Thread: M25 x 1.5; 20 pc; for installation in lights; in moulded material; without counter nut	138576 ▲	0.200
Cover frame to provide IP66			
	for 280 mm width made of sheet steel powder coated	245988	2.249
	for 280 mm width made of stainless steel SS316L (V4A 1.4404)	245990	2.279
	for size 6 standard luminaire or size 4 emergency luminaire with 280 mm width made of sheet steel powder coated	245976	3.731
	for size 6 standard luminaire or size 4 emergency luminaire with 280 mm width made of stainless steel SS316L (V4A 1.4404)	245978	3.781



Emergency Luminaire for Fluorescent Lamps

Series 6018/1 made of Sheet Steel or Stainless Steel

STAHL

18W END!

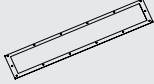
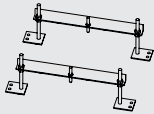
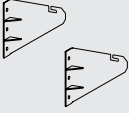
Accessories

Figure	Description	Art. No.	Weight kg
Flushing frame for recessed mounting in ceiling or wall with provide IP66			
	for 280 mm width made of sheet steel powder coated	226579	3.153
	for 280 mm width made of stainless steel SS316L (V4A 1.4404)	226581	3.203
	for size 6 standard luminaire or size 4 emergency luminaire with 280 mm width made of sheet steel powder coated	226557	4.711
	for size 6 standard luminaire or size 4 emergency luminaire with 280 mm width made of stainless steel SS316L (V4A 1.4404)	226559	4.781
Mounting set for recessed mounting in ceiling or wall			
	for Version 280 mm width	230082	1.644
Mounting set wall			
	for version with 280 mm width	226700	1.733
Ring bolt			
	M8, direct mounting in insert nuts; 1 pair	115736 ▲	0.115

Spare Parts

Figure	Description	Art. No.	Weight kg
Fluorescent lamp			
	36 W, 3350 lm	108951 ▲	0.200
	18 W, 1350 lm	108952 ▲	0.100
Accessories and spare parts see N/A			

Dimensional Drawings (All Dimensions in mm [inches]) – Subject to Alterations

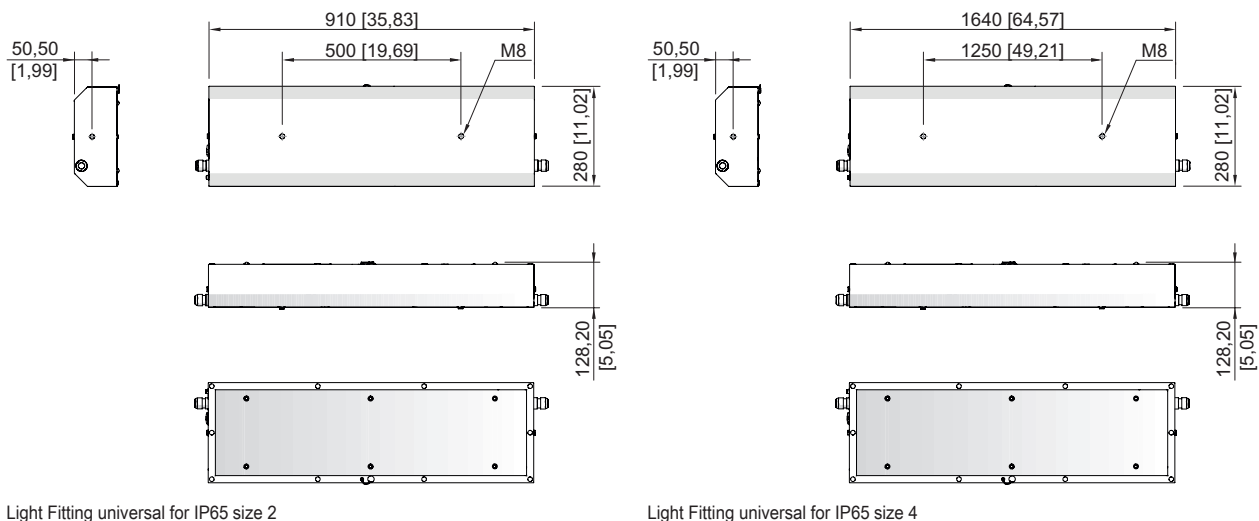

18W END!

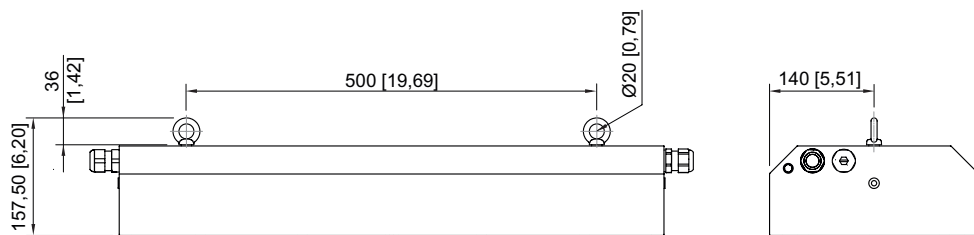

Mounting with ring bolts size 2

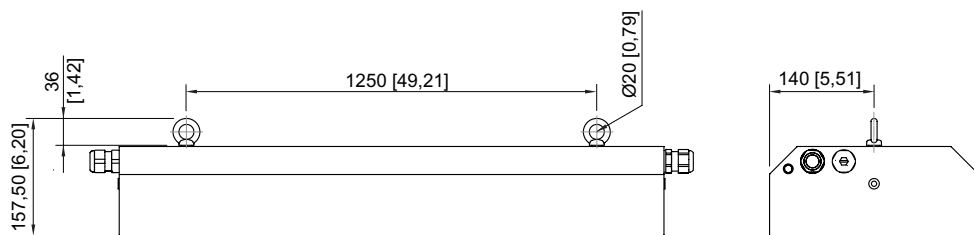

Mounting with ring bolts size 4

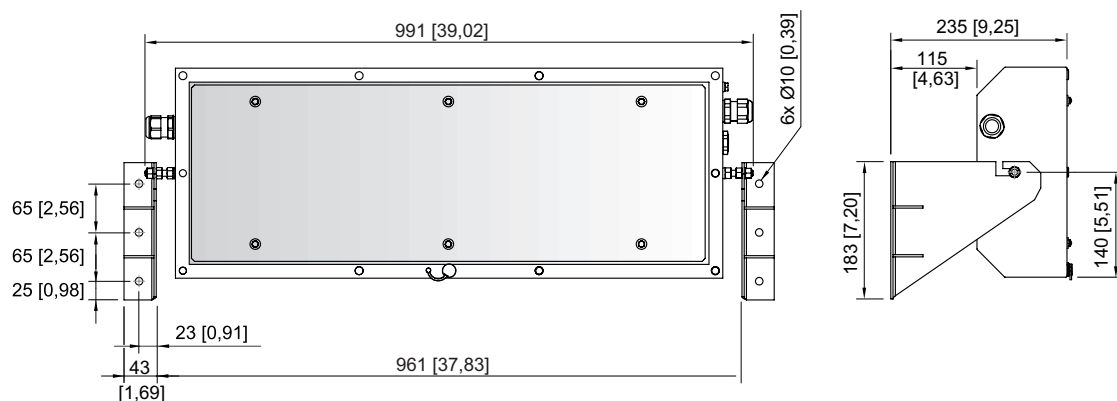

Mounting on wall or ceiling size 2

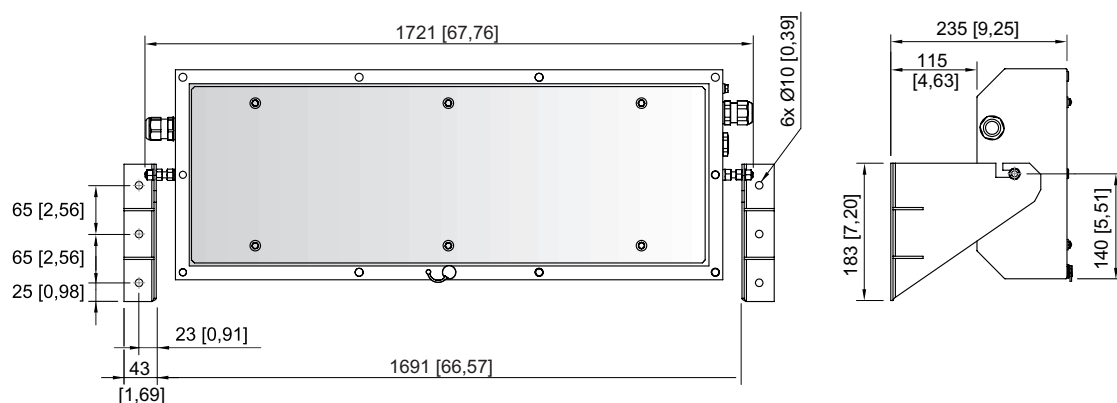

Mounting on wall or ceiling size 4

Emergency Luminaire for Fluorescent Lamps

Series 6018/1 made of Sheet Steel or Stainless Steel

STAHL

18W/END!

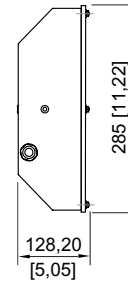
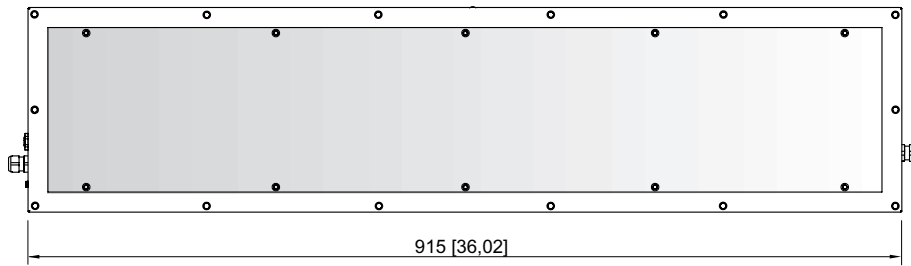

Luminaire wall or ceiling mounting with frame for IP66 size 2

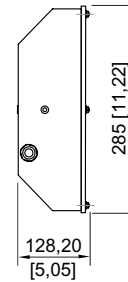
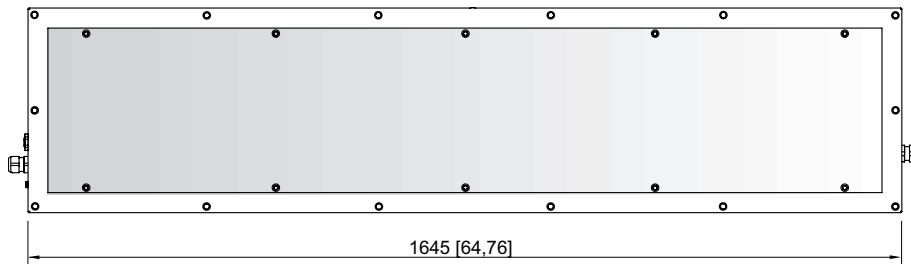

Luminaire wall or ceiling mounting with frame for IP66 size 4

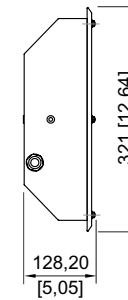
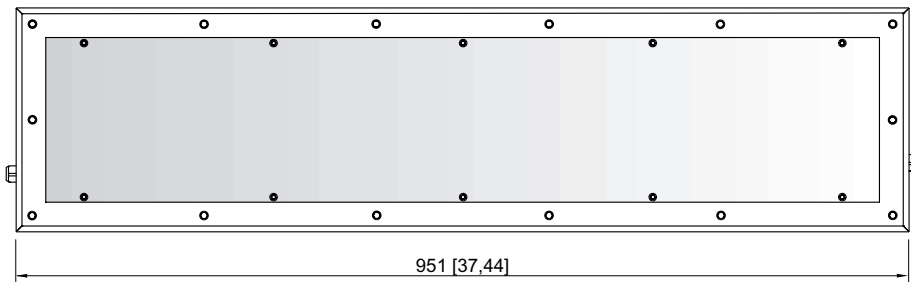

Luminaire universal with mounting frame for IP66 size 2

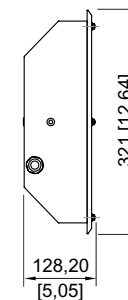
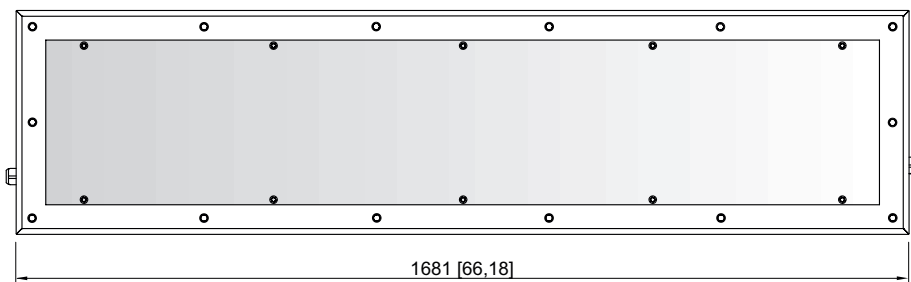

Luminaire universal with mounting frame for IP66 size 4

18W END!

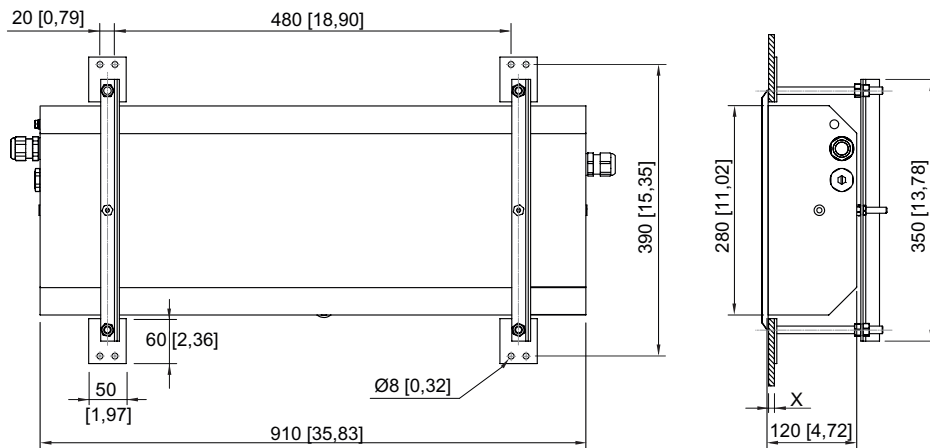

X = 10 [0,39] ... 125 [4,92]

Recessed mounting on wall or ceiling size 2

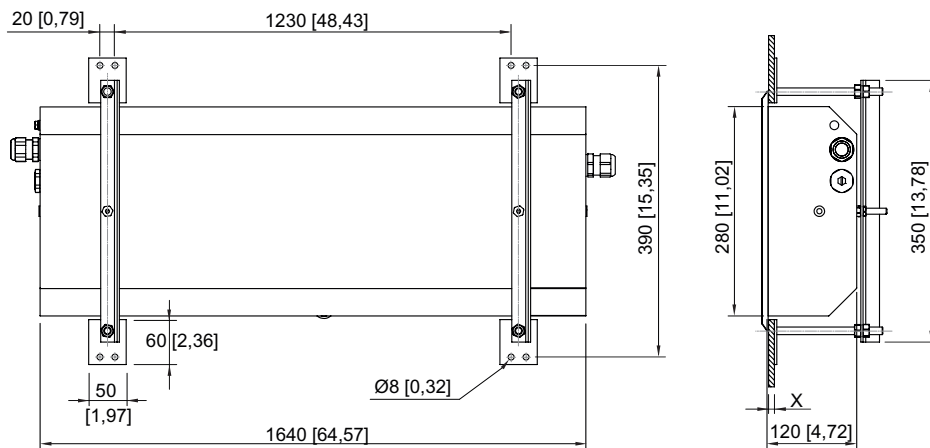

X = 10 [0,39] ... 125 [4,92]

Recessed mounting on wall or ceiling size 4

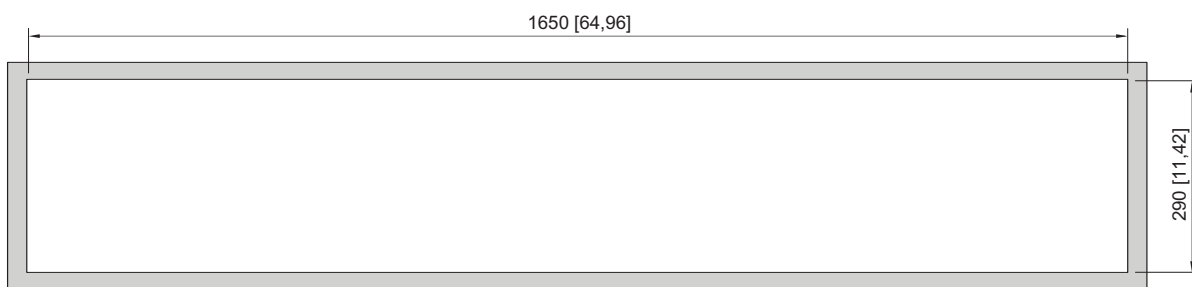

Mounting Cut-Out Size 4

Emergency Luminaire for Fluorescent Lamps

Series 6018/1 made of Sheet Steel or Stainless Steel



18W ENEC

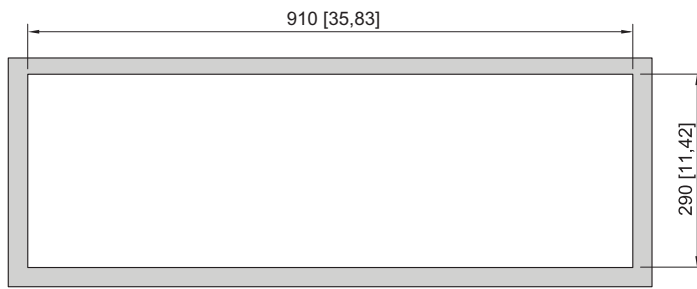

Mounting Cut-Out Size 2